

Schnellverschlußkupplungen ISO "A" Push-Pull

**Quick release
Push-Pull
couplings PP**

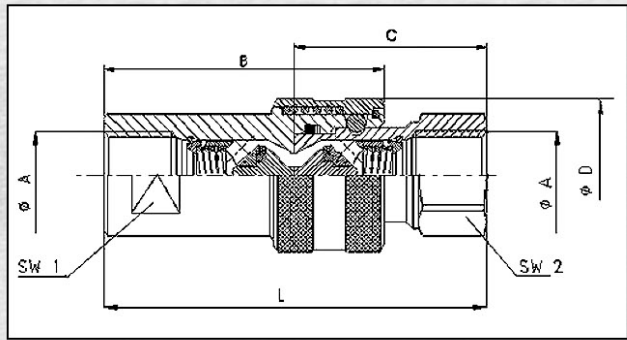

Anwendungen in Landwirtschaft und Industrie. Austauschbar nach ISO 7241-1 „A“ Größe 08. Diese Anschlüsse erweitern das Angebot und minimiert Kosten für Adapter.
Material: A3C, Dichtungen: Nitril und PTFE, Arbeitstemperaturen von -15° C bis +125° C.

These couplings are the most used both in agriculture and industry. Interchangeable to ISO 7241-1 "A" Male, high grade carbon steel, induction hardened. The complete assembly galvanized and white passivated. Standard seals in nitrile rubber and pure PTFE. Working temperature with standard seals from -15° C to +125° C.

		Größe Size DN	Gewinde Thread	Diam	Bestell-Nr. / Order-No. Muffe Female		Stecker Male		Preis / Price € Muffe Female		Stecker Male	
Innengewinde <i>Female-thread</i>		08	M 18x1,5		PPT18IF	PPT18IM			*)	*)		
		08	R 3/8"		PPT38F	PP38M			*)	*)		
		10	M 22x1,5		IR22FPP	IR22M			*)	*)		
		10	R 1/2"		IR12FPP	IR12M			*)	*)		
Außengewinde L <i>Male-thread L</i>	DIN 2353 leicht <i>DIN 2353 light</i>	06	M14x1,5	8L	PPT14F	PPT14M			*)	*)		
		08	M16x1,5	10L	PPT16F	PPT16M			*)	*)		
		10	M18x1,5	12L	PPT18F	PPT18M			*)	*)		
		13	M22x1,5	15L	PPT22F	PPT22M			*)	*)		
Außengewinde S <i>Male-thread S</i>	DIN 2353 schwer <i>DIN 2353 heavy</i>	06	M18x1,5	10S	PPT18SF	PPT18SM			*)	*)		
		08	M20x1,5	12S	PPT20SF	PPT20SM			*)	*)		
		10	M22x1,5	14S	PPT22SF	PPT22SM			*)	*)		
		13	M24x1,5	16S	PPT24SF	PPT24SM			*)	*)		
Langes Gewinde L <i>Male Long-thread L</i>	DIN 2353 leicht <i>DIN 2353 light</i>	06	M14x1,5	8L	PPT14FL	PPT14ML			*)	*)		
		08	M16x1,5	10L	PPT16FL	PPT16ML			*)	*)		
		10	M18x1,5	12L	PPT18FL	PPT18ML			*)	*)		
		13	M22x1,5	15L	PPT22FL	PPT22ML			*)	*)		
Langes Gewinde S <i>Male Long-thread S</i>	DIN 2353 schwer <i>DIN 2353 heavy</i>	06	M18x1,5	10S	PPT18SFL	PPT18SML			*)	*)		
		08	M20x1,5	12S	PPT20SFL	PPT20SML			*)	*)		
		10	M22x1,5	14S	PPT22SFL	PPT22SML			*)	*)		
		13	M24x1,5	16S	PPT24SFL	PPT24SML			*)	*)		

*) Bitte Preisliste anfordern!
*) Please, request price list!