

## Zölliger Dichtkopf DKR

mit BSP Überwurfmutter, Schraubarmatur

### BSP Swivel Female DKR

Cone 60°, Reusable

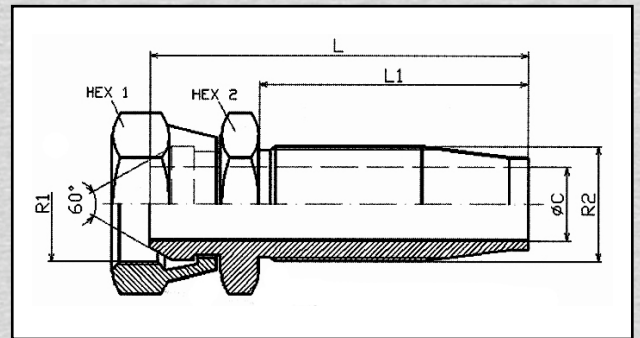

Schlauch Hose DN	Hose inch	Gewinde Thread R1	Gewinde Thread R2	Maßzahlen Dimensions					Artikel Article	Bestell-Nummer Order-No.	Preis Price €
				L	L1	C	HEX 1	HEX 2			
06	1/4"	1/4"	7/16" UNF	61	43	4	17	19	Z3G- 4	Z3 DKR 1.4 - DN 06	*)
10	3/8"	3/8"	9/16" UNF	67,5	48	7	22	22	Z3G- 6	Z3 DKR 3.8 - DN 10	*)
12	1/2"	1/2"	5/8" UNF	71,5	50	8	27	27	Z3G- 8	Z3 DKR 1.2 - DN 12	*)
20	3/4"	3/4"	M22x1,5	87,5	63	14	32	32	Z3G-12	Z3 DKR 3.4 - DN 20	*)
25	1"	1"	29.9 UNF	101	71	19	41	41	Z3G-16	Z3 DKR 1.1 - DN 25	*)

## Dichtkopf DKR 90°

mit BSP Überwurfmutter, Schraubarmatur  
90° Bogen

### BSP 90° Swivel Female

with Cone 60°, Reusable

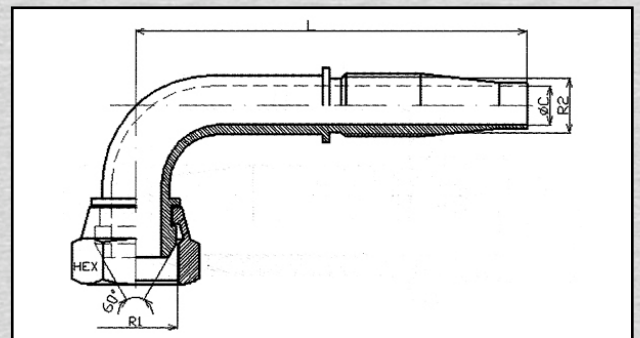

Schlauch Hose DN	Hose inch	Gewinde Thread R1	Gewinde Thread R2	Maßzahlen Dimensions				Artikel Article	Bestell-Nummer Order-No.	Preis Price €
				L	L1	C	HEX			
06	1/4"	1/4"	7/16" UNF	70	43	4	19	Z90G- 4	Z90 DKR 1.4 - DN 06	*)
10	3/8"	3/8"	9/16" UNF	80	48	7	22	Z90G- 6	Z90 DKR 3.8 - DN 10	*)
12	1/2"	1/2"	5/8" UNF	88	50	8	27	Z90G- 8	Z90 DKR 1.2 - DN 12	*)
20	3/4"	3/4"	M22x1.5	112	63	14	32	Z90G-12	Z90 DKR 3.4 - DN 20	*)
25	1"	1"	29.9 UNF	132	71	19	41	Z90G-16	Z90 DKR 1.1 - DN 25	*)

\*) Bitte Preisliste anfordern!  
\*) Please, request price list!