

## Schnellverschluß-Schraubkupplungen IV

*Quick release screw on couplings IV*

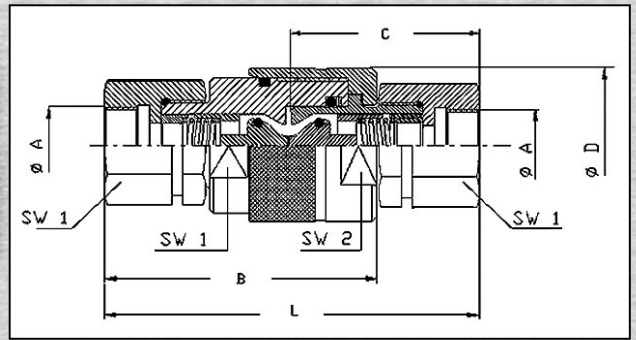

Schnellverschluß Schraubkupplung in Edelstahl AISI 316L. Diese Kupplung wird durch verschrauben von Muffen und Stecker bis zum Anschlag verbunden. Austauschbar mit allen gängigen Produkten der Baugröße 3. O-Ring in Viton (FPM), Stützring in PTFE, Arbeitstemperaturen von -30° C bis +150° C.

*Material: stainless steel AISI 316 These couplings are the most used in off shore, industry and chemical. These couplings are coupled by means of a screwed sleeve. This permits the coupling operation to be carried out even with the male or female under pressure. This type of coupling is particularly prevalent in the German market, and is interchangeable with the majority of those locally manufactured. Standard seals in VITON rubber and pure PTFE. Working temperature with standard seals from -30° C to +150° C.*

Größe Size DN	Ø A BSP inch	Maße / Dimensions							M kg	P bar	Bestell-Nummer / Order-No.		Preis / Price €	
		B mm	C mm	Ø D mm	L mm	SW1 mm	SW2 mm	SW3 mm			Muffe Female	Stecker Male	Muffe Female	Stecker Male
04	1/4 "	59	58	30	92	19	27	22	0,22	300	IV14F	IV14M	*)	*)
06	3/8"	64,5	62	34	102	24	30	42	0,34	250	IV38F	IV38M	*)	*)
08	1/2"	67	63	42	102	30	38	75	0,60	250	IV12F	IV12M	*)	*)
12	3/4"	82	75	48	123	36	36	138	0,29	250	IV34F	IV34M	*)	*)
16	1"	95	78,5	55	138	41	41	230	1,30	250	IV10F	IV10M	*)	*)
20	1 1/4"	116	107	80	187	60	75	522	4,20	200	IV114	IV114M	*)	*)
24	1 1/2"	116	107	80	187	60	75	522	4,20	200	IV112	IV112M	*)	*)

\*) Bitte Preisliste anfordern!  
\*) Please, request price list!